

## RadExPro 2017.2 release notes

We are happy to announce that our next release is ready -- meet **RadExPro 2017.2** !

Here is the list of what is new or improved:

- One of the main novelties is the brand-new **Geometry Spreadsheet** – a beta version. You can call it through the context menu of a dataset in the *Database Navigator* -- select *Geometry spreadsheet (NEW)* command.

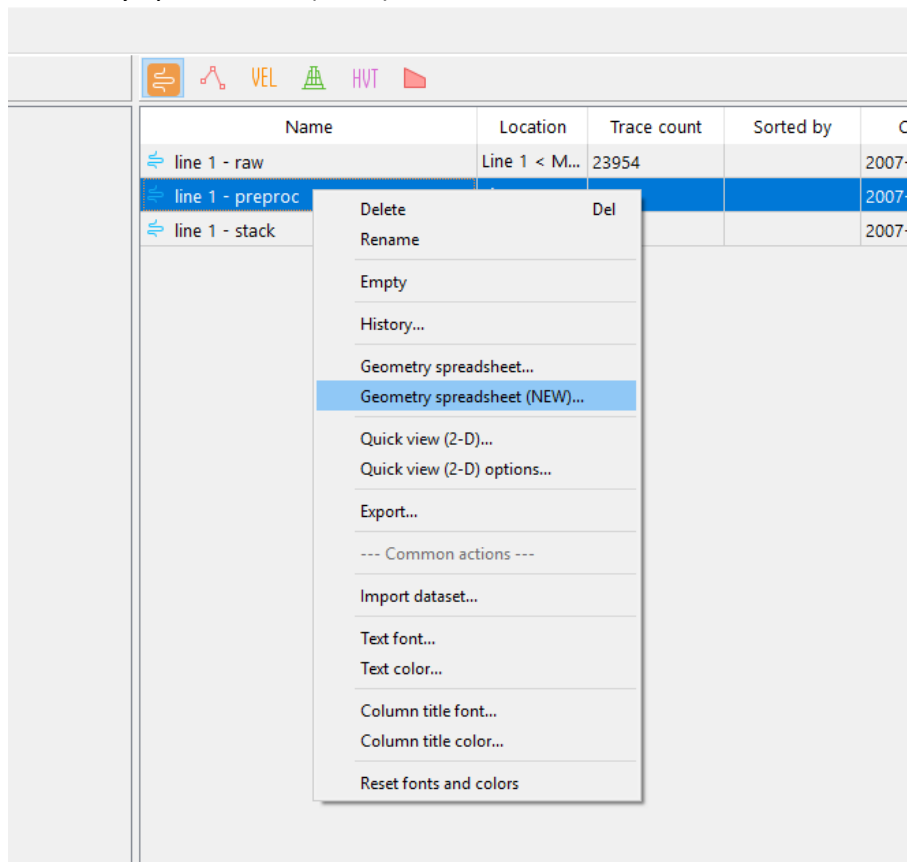

Never miss any of our news! Follow RadExPro in social media:



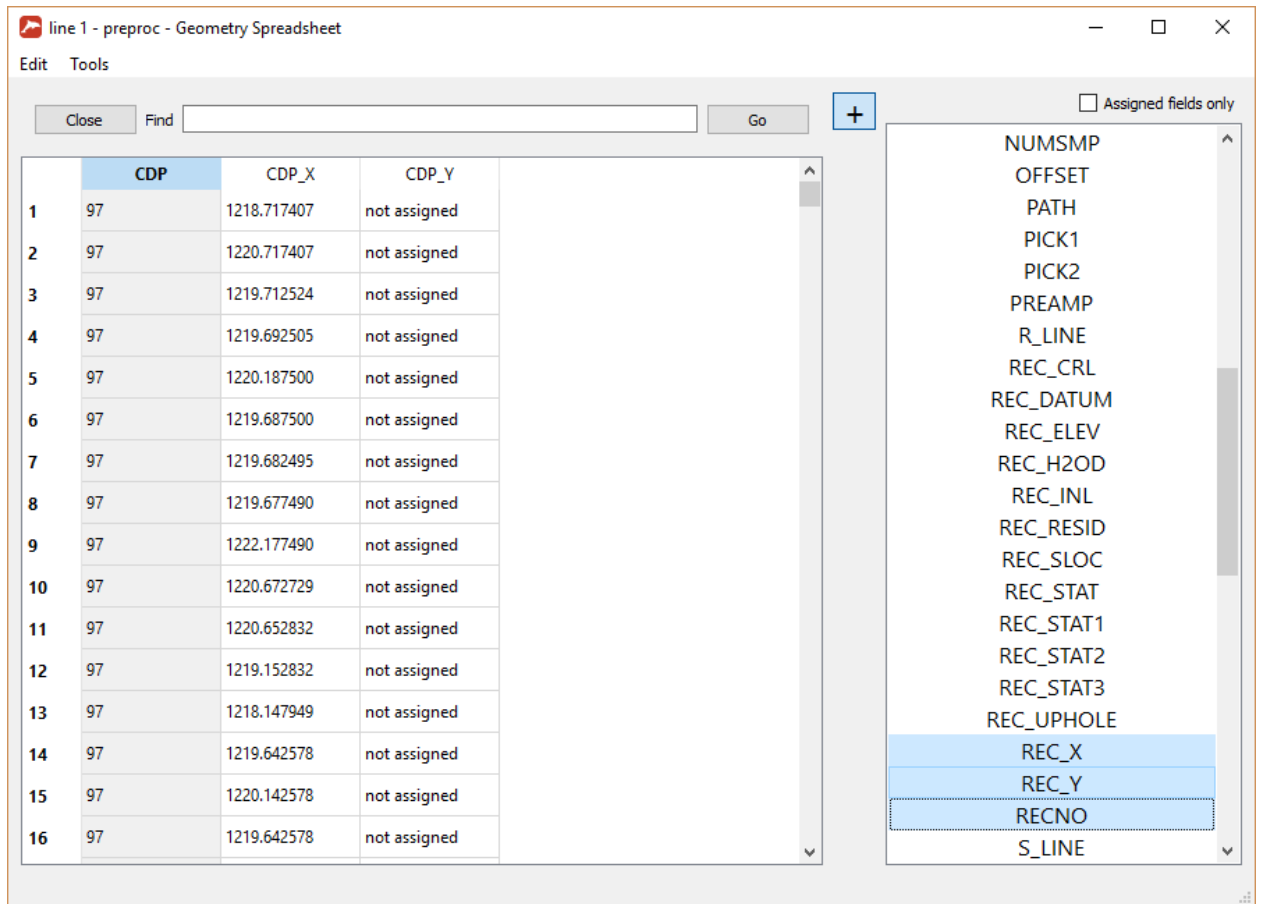

The **Geometry Spreadsheet (NEW)** operates much faster with big datasets, plus it offers some nice new features. You can add headers to the spreadsheet from the list on the right by drag-and-drop or double click, change positions of a column by drag and drop, there is a convenient *Find* option (Ctrl+F) that would search for a specified value with the accuracy of the significand. This allow approximate search, as shown on the figure below:

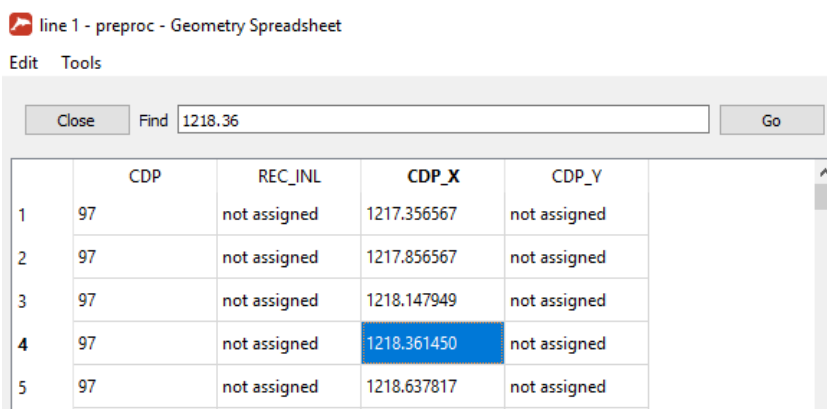

We encourage you to use the **Geometry Spreadsheet (NEW)** instead of the old one and report us any bugs and issues. The plan is that in the next release, the **Geometry Spreadsheet (NEW)** will completely substitute the old one.

Never miss any of our news! Follow RadExPro in social media:



- We have changed the syntax of **Trace Header Math** formulas and got rid of the annoying [ ] decorating header names. You don't need them anymore! (The old syntax still works for backward compatibility). We have also added 2 new functions: ***frame\_min(HEADER\_NAME)*** and ***frame\_max(HEADER\_NAME)***. They return the minimum and the maximum values of a specified header within the current frame.

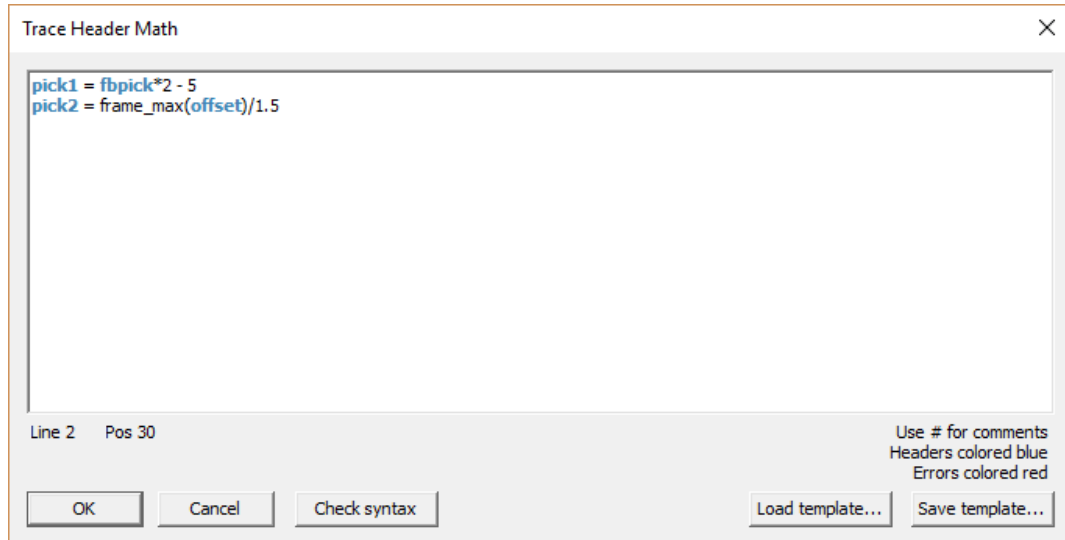

- Brand-new **Linear Moveout Correction** module can apply and remove LMO-corrections with a constant velocity.

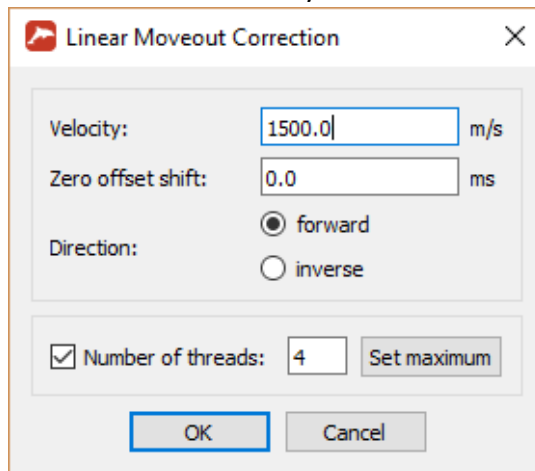

- Brand-new **2D Flex Binning** module helps to achieve regular offset distribution in case of originally not very regular 2D operations, such as multichannel marine HRS/UHRS possibly with some missed shots.

Never miss any of our news! Follow RadExPro in social media:



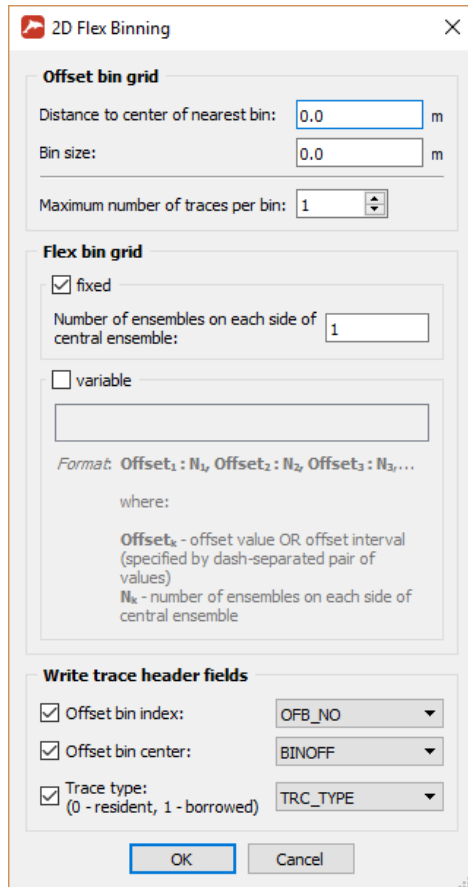

- Now it is possible to **export your list of headers and import it to another project.**

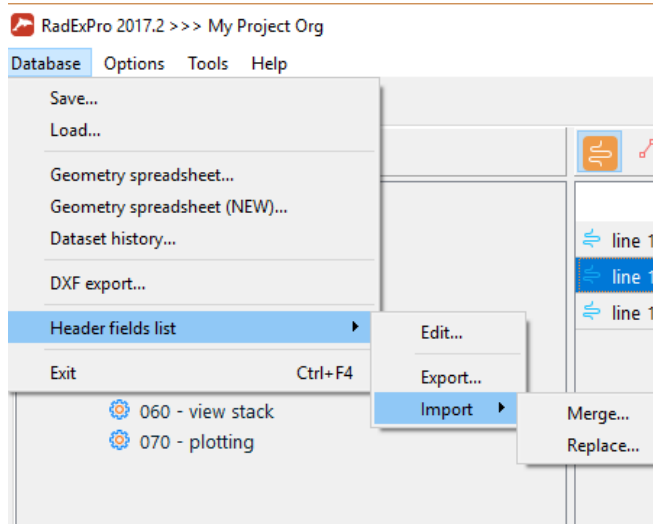

Never miss any of our news! Follow RadExPro in social media:



- Now in the **NMO/NMI** module you can adjust velocity function at a specified percentage before applying NMO-correction.

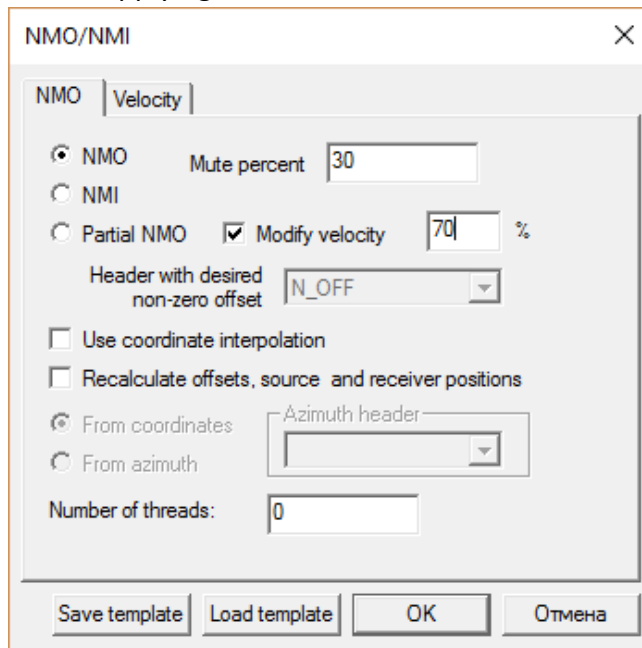

- Now you can apply simple arithmetic operations to pick values in the **Edit pick** table. Right click of the column name and call the *Math...* dialog:

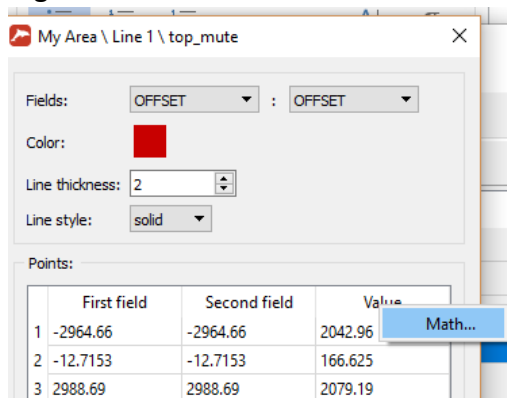

Never miss any of our news! Follow RadExPro in social media:



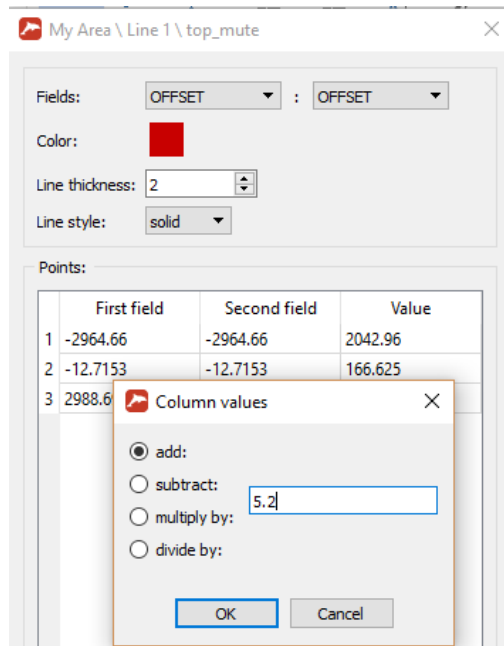

- In **Time/Depth Conversion** module, in the *Single velocity function* field you can substitute any time value with a header name. This option makes it possible to define velocities referring to non-constant picked horizons.

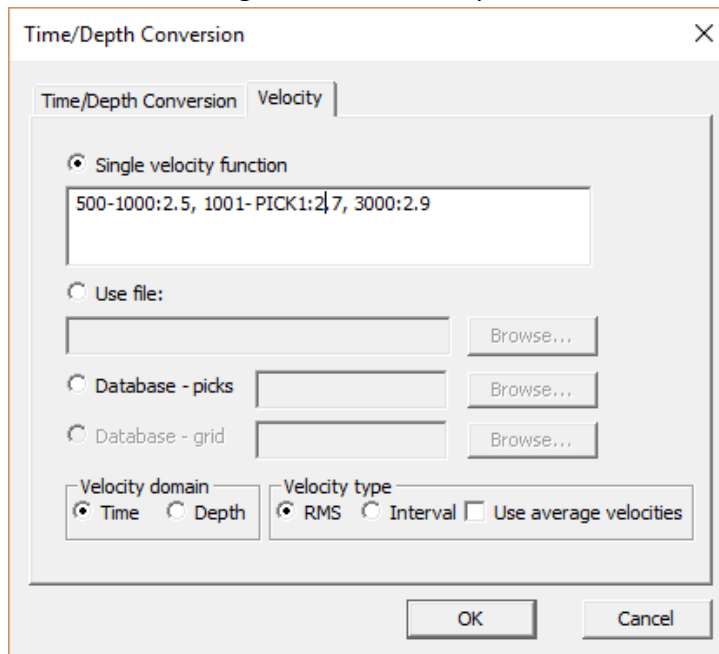

Never miss any of our news! Follow RadExPro in social media:



- In **Trace Math Transforms** module, we have added an option to unwrap phase spectrum

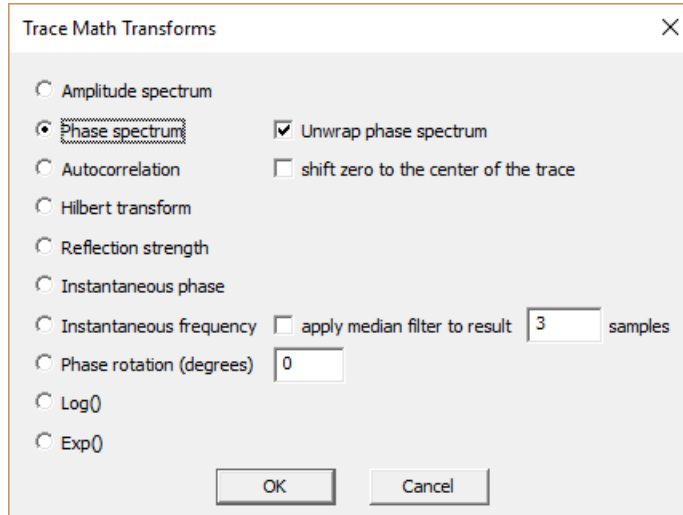

- In **Zero-Offset Demultiple** module, now you can apply additional static corrections to compensate the multiple for swelling, before subtracting the model.

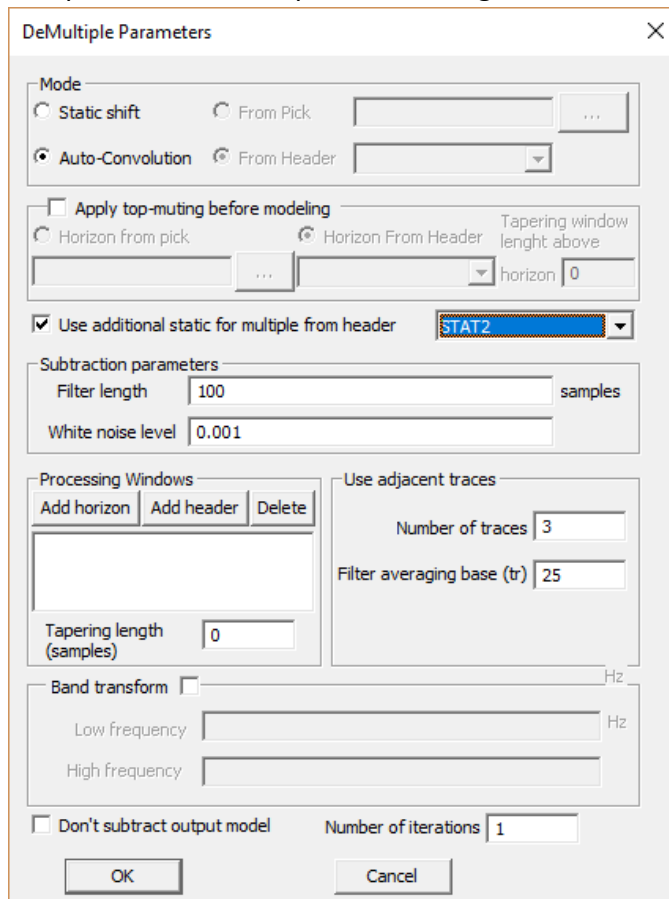

- A number of bugs were fixed, including minor fixes in **Calculate Statics 3D** and **MaxPower Autostatics** modules, fixed axes orientation XYZ display in **3D Volume**

Never miss any of our news! Follow RadExPro in social media:



27.06.2017

DECO Geophysical Software Company

[www.radepro.com](http://www.radepro.com)

**Viewer**, fixed issues with decimals in *Taper window length* in **Trace Editing** and *Time Window* in **F-X Predictive Filtering**, and some others.

As usual, if you are on maintenance, please contact us at [support@radepro.ru](mailto:support@radepro.ru) and get your update for free.

Never miss any of our news! Follow RadExPro in social media:

